

**LEVEL: ORDINAL LEVEL (S3)**

**SUBJECT: GEOGRAPHY AND ENVIRONMENT**

**HOLYDAYS WORK**

**Instructions:**

This exam is composed of 3 parts

**PART I: PHYSICAL GEOGRAPHY**

**PART II: HUMAN AND ECONOMIC GEOGRAPHY**

**PART III: PHOTOGRAPHIC INTERPRETATION**

**PAPER I: PHYSICAL GEOGRAPHY**

**PART I: PHYSICAL GEOGRAPHY /60marks**

1. Complete the following sentences with one of the proposed terms to make them meaningful.

**Rotation, Bearing, Revolution, Latitude, Grid reference Longitude, Contours,**  
**(5marks)**

- a) is the angular distance of a place east or west of the Greenwich Meridian .....
- b) the movement of the earth on its orbit around the sun is called.....
- c).....is the direction measured as an angle and given in degrees.
- d) Lines drawn on a map joining areas with the same altitude/height above sea level is called.....
- e) A pair of Eastings and Northings in locating features on a map are called.....

2. The external structure of the earth is made up of: **(1mark)**

- a) Hydrosphere, Lithosphere, Biosphere, Atmosphere
- b) Crust, Mantle, Core
- c) Hydrosphere, crust, Biosphere, Lithosphere

3. The damaging of the ozone layer by air pollutants is called: **(1mark)**

- A. Climate change    B. Ozone depletion    C. Atmospheric windows.

4. This is the breakdown of a rock into smaller fragments, with its mineral or chemical composition remaining the same. This type of weathering is called: **(1mark)**

A. Biological weathering      B. Physical weathering      C. Chemical weathering.

5. The following are the types of soils found in Africa except: **(1mark)**

A. Ferralitic soils      B. Tundra soils      C. Vertisols      D. Desert soils

6. Which of the following combination comprises main parts of photograph. **(1mark)**

a) Aerial, Ground, Foreground

b) Foreground, Middle ground, Background.

c) Dead ground, Foreground, Middle ground, Background.

d) All answers are correct

7. State the instruments used to measure the following weather elements. **(3marks)**

a) Temperature .....

b) Rainfall .....

c) Atmospheric pressure .....

8. Which type of eclipse is shown in the picture below?. justify your answer **(3 mark)**

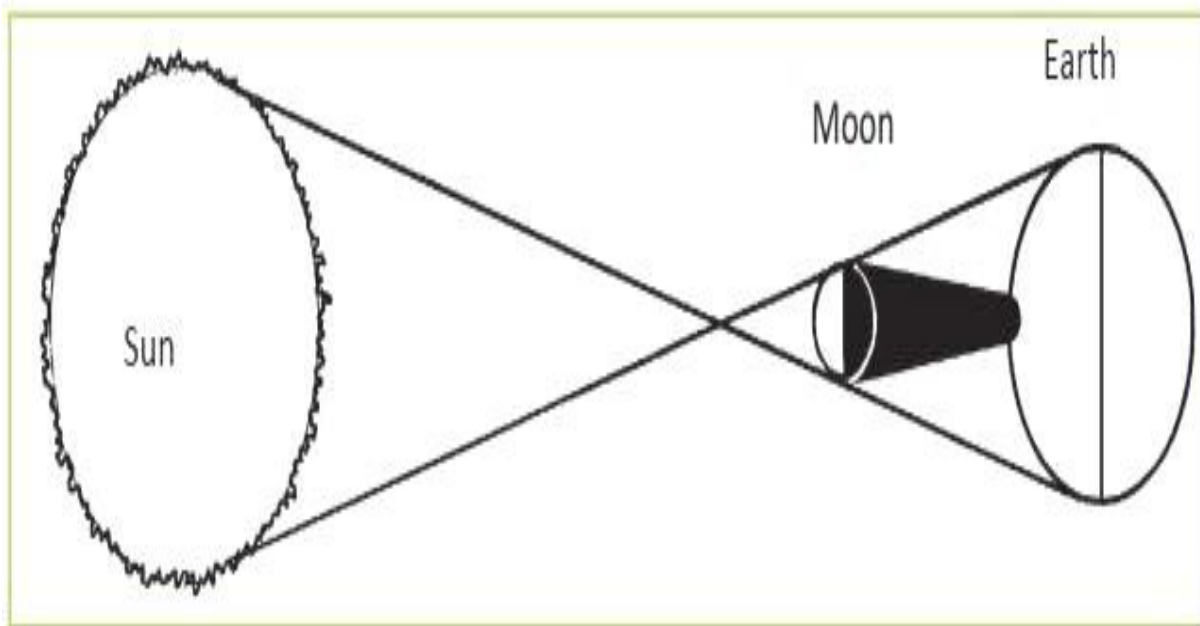

9. Differentiate between map reduction and map enlargement **( 2marks)**

10. Explain any 3 economic importances of rocks to man. **(3marks)**

11. Analyze the impacts of relief features on: **(4marks)**

a) Settlement

b) Agriculture

12. a) Study the following types of rural settlements and name them as marked by letters:  
**(3marks)**

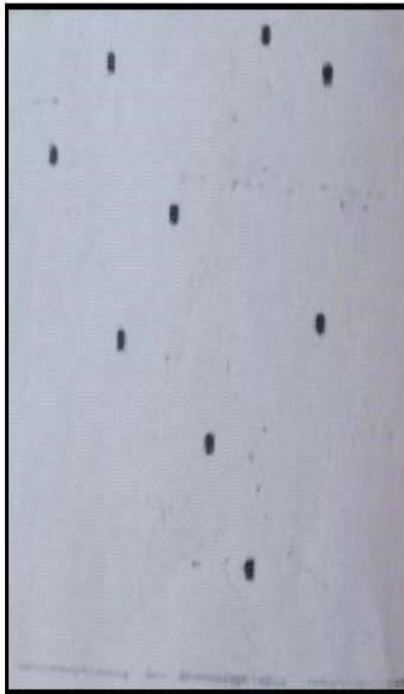

**A**

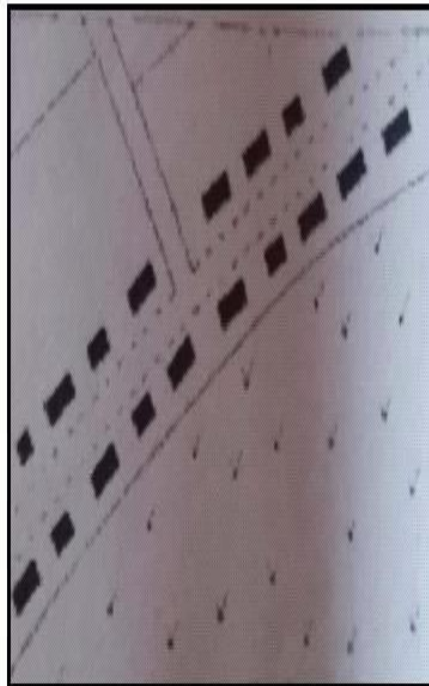

**B**

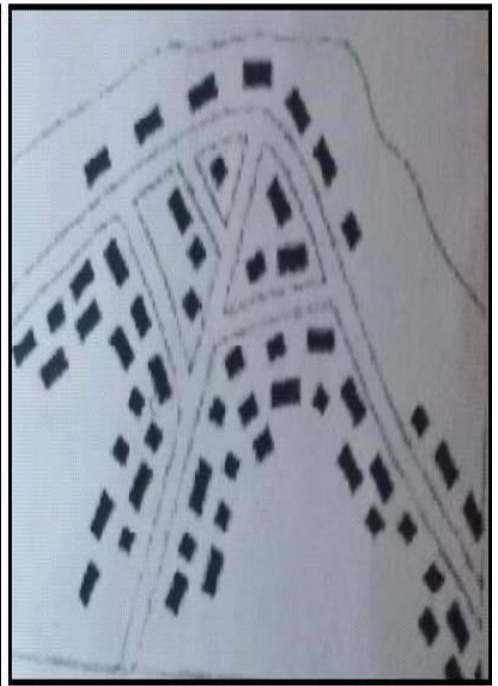

**C**

b) Give two characteristics of settlement type **B** from the diagram above **(2marks)**

13. a) Classify the following features into the correct column. **(6marks)**

**Batholith, Hot springs, Volcanic Mountain, Sill, Dyke, Lava dammed**

**Lakes.**

Intrusive volcanic features	Extrusive volcanic features
-----------------------------	-----------------------------

1.	1.
2.	2.
3.	3.

b) Describe the two positive influence of volcanic mountain to human activities ( **2marks**)

c) Distinguish between 3 types of volcano ( **3marks**)

14. a) Differentiate between weather and climate ( **2mark**)

b) State any three characteristics of semi- arid climate ( **3marks**)

c) Describe any 3 positive impacts of climate on human activities ( **3marks**)

15. a) Define the term flooding. ( **2marks**)

b) Mention any 3 effects of floods in Rwanda? ( **3marks**)

( **4marks**)

16. The diagram below is a composite volcano, Study it and answer the questions that follow:

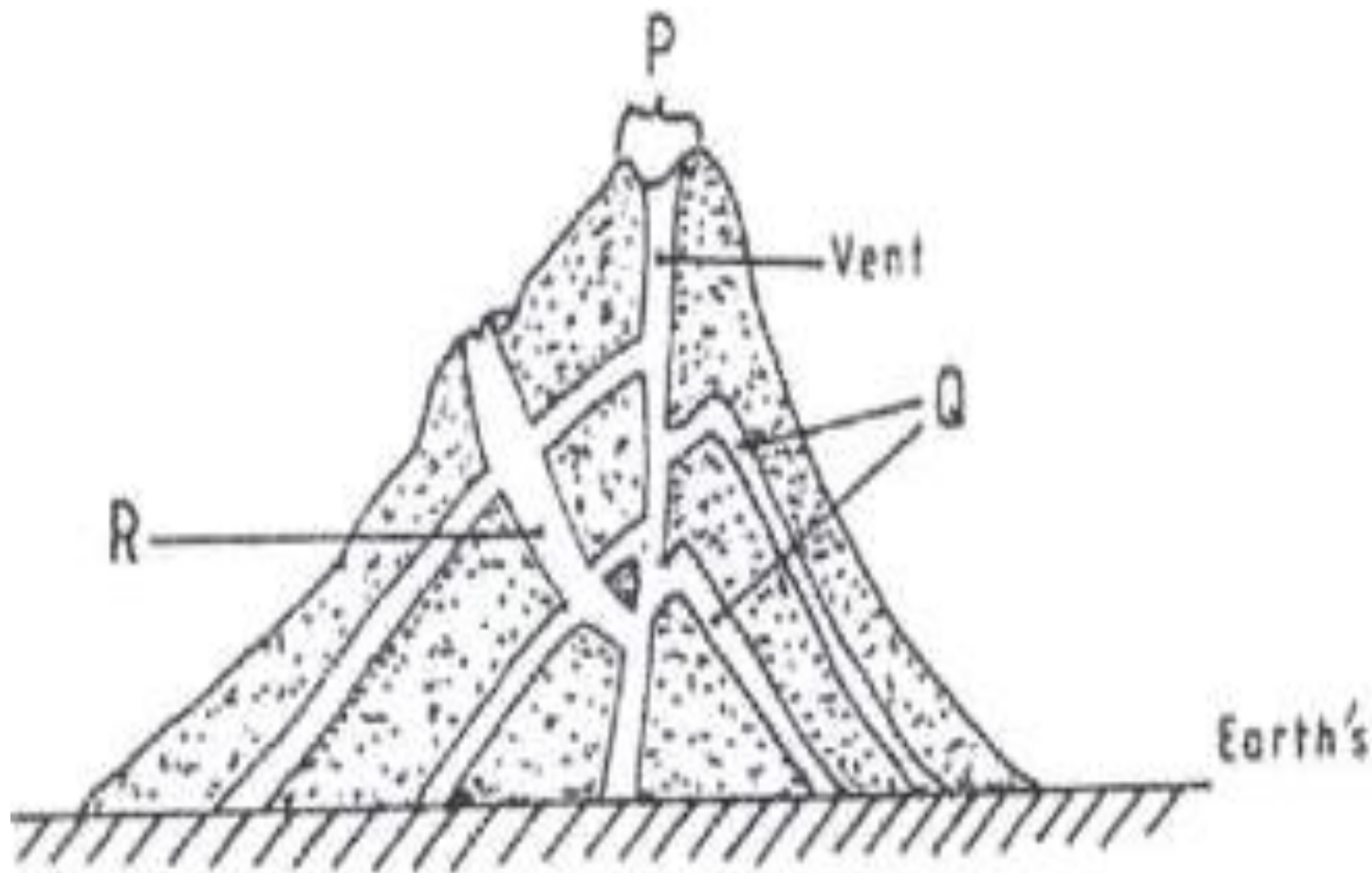

- Name the parts marked by letters **P, Q, R** (3marks)
- Explain 3 reasons why northern part of Rwanda experiences land slide (3marks)
- Examine any 4 ways in which volcanic features are of economic importance. (4marks)

## **PAPER II: HUMAN AND ECONOMIC GEOGRAPHY /30marks**

17. The type of agriculture system that involves the growth of crops for home consumption is known as .....(1mark)

- a)** Commercial agriculture   **b)** Subsistence agriculture   **c)** Livestock farming

18. ....is the growing of a single crop on a large scale for sale. (1mark)

- a.** Plantation farming   **b.** Irrigation farming   **c.** Subsistence agriculture.

19. It is the form of rearing whereby animals are kept in closed room and provided with

feeds and water. This is called.....(1mark)

20. a) Differentiate between mining and quarrying (4marks)

b) Identify any 3 effects of mining on the natural environment in Rwanda. (3marks)

21. With examples, Differentiate between Renewable and non-renewable energy resources. (4marks)

22. a) Name any 3 tourist attraction sites in Rwanda (3marks)

b) Explain 3 economic importance of Akagera national park in Rwanda. (3marks)

23. a) Define the term Population density (1marks)

b) Calculate the population density of Rwanda where total area is 26,338 with population size of 13,246,394. (2marks)

24.a) What do you understand by “irrigation farming” (1mark)

b) Identify any 3 benefits of irrigation farming (3marks)

25.a) Define the term **nomadic pastoralism** (1mark)

b) Explain 3 problems faced by nomadic pastoralism (3marks)

26. Account for the factors affecting fishing in Rwanda (4marks)

### **PART III: PHOTOGRAPHIC INTERPRETATION /10marks**

27. Study the photograph below and answer the questions that follow. (10marks)





- a) What is the main activity shown in the photograph above? **(2marks)**
- b) Name one geographical region in Rwanda where the activity may have been taken. **(2marks)**
- c) Explain the geographical condition that favor the activity identified in the photograph above **(3marks)**
- d) Discuss the problems faced by the economic activity mentioned in ( 27 a) above **(3mark)**